

## SPECIFICATIONS J-Type Inclined Moving Walks

### Standard Specifications

Type	1200	
	MS-LE/LB, MS-E/B	
Use	General use	
Environment	Indoor	
Application code	JAPAN/EN115	
Width of pallet (mm)	1006	
Width of Moving Walk (mm)	1550	
Width between handrails (mm)	MS-LE/LB, MS-E/B	1280
Width between skirt panels (mm)	1010	
Carrying capacity (persons/hour)	9000	
Speed (m/min)	30	
Inclination angle (degree)	12	
Maximum rise (mm)	6500	

### Standard Safety Features

Key operated start switches with buzzer
Emergency stop buttons
Speed governor (Moving Walks speed governor)
Broken pallet-chain device (Pallet-chain safety device)
Broken drive-chain device (Drive-chain safety device)
Reversal stop device (Moving Walks speed governor)
Pallet level device (Option for JAPAN code)
Handrail entry device (Inlet guards)
Comb-pallet impact device (Option for JAPAN code)
Anti-slip pallet
Anti-slip floorplate
Overload protection

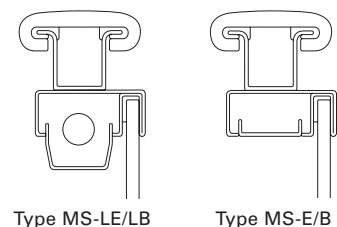

### Operation Feature (Option)

Automatic operation (Post type)
---------------------------------

### Finishes

Type			MS-E/B	MS-LE/LB
Balustrade	Interior panel	Standard	Vertical, flat, clear rectangular 8mm tempered-glass panel	
		Option	Vertical, flat, clear rectangular 10mm tempered-glass panel	
			Vertical, flat, clear parallelogram 8 or 10mm tempered-glass panel	
	Deckboard		Hairline-finished stainless steel plate	
	Skirt guard	Standard	Hairline-finished stainless steel plate	
		Option	Black resin coating with a low friction coefficient	
Illumination	Standard	None	Under handrail lighting	
	Option	Pallet demarcation light / Comb light		
Handrail color	See page 4			
	Guardrail	Stainless steel		
Pallet	Standard	Die-cast aluminum alloy with black painted groove		
	Option	With painted demarcation cleat See page 4 for the actual color		
Floorplate	Comb	Die-cast aluminum alloy		
	Comb plate, landing plate, manhole cover	Standard	Stainless steel plates with anti-slip pattern	
Option		Stainless steel plates with anti-slip pattern, full coverage floorplate		

### Color Samples for Moving Handrails\*

\*The actual color of the moving handrails may differ slightly from the image shown due to printing limitations.

Standard				
	Black (No.001)	Vermilion (No.502)	Red (No.503)	Yellow (No.504)
Option				
	Green (No.505)	Blue (No.506)	Gray (No.507)	Brown (No.508)
Option				
	Royal red (No.509)	Royal green (No.510)	Beige (No.511)	Black as dark gray tone (No.501)

### Optional Color for Demarcation Cleats\*

\*The actual color of the demarcation cleats may differ slightly from the image shown due to printing limitations.

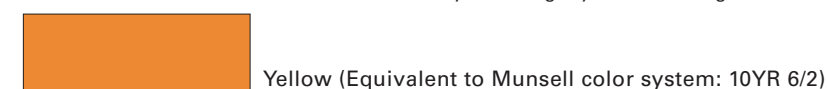

#### 1 Essential Shopping Cart Requirements

- All shopping carts to be used on Moving Walks must have four wheels. All four wheels must have a brake mechanism similar to "Examples of Brake Mechanism" shown below. ALL WHEELS MUST BRAKE AUTOMATICALLY WHEN ROLLED ONTO THE PALLET.
- All roller disks, not only those on the two wheels on either side, must fit into the grooves between the pallet cleats as shown in "Pallet Section" below.
- The weight of a loaded shopping cart must not exceed 780N.

#### 2 Confirmation by Test

Before starting the operation of Moving Walks for public use, it is essential to ensure by actual tests using loaded shopping carts in both up and down directions that: 1) the carts are easily pushed onto the pallet from the floorplate when boarding; 2) the brakes are fully functional through the entire travel on the pallets from boarding to landing; and 3) the carts smoothly roll over the comb from the pallet when landing.

#### Examples of Brake Mechanism (All brake automatically on boarding the pallet)

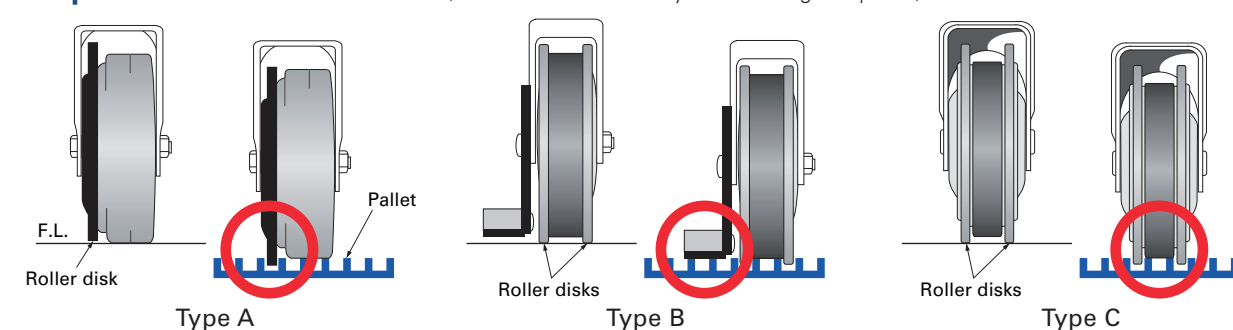

#### Pallet Section

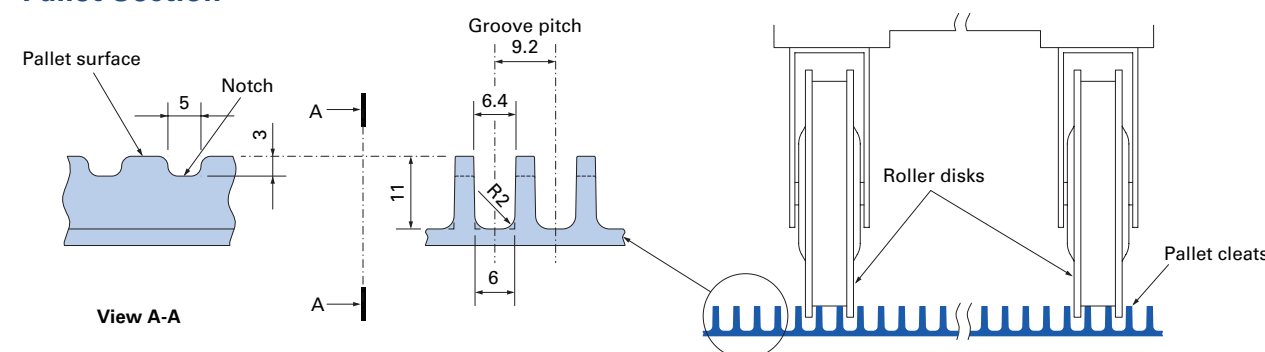

STANDARD INSTALLATIONS J-Type Inclined Moving Walks

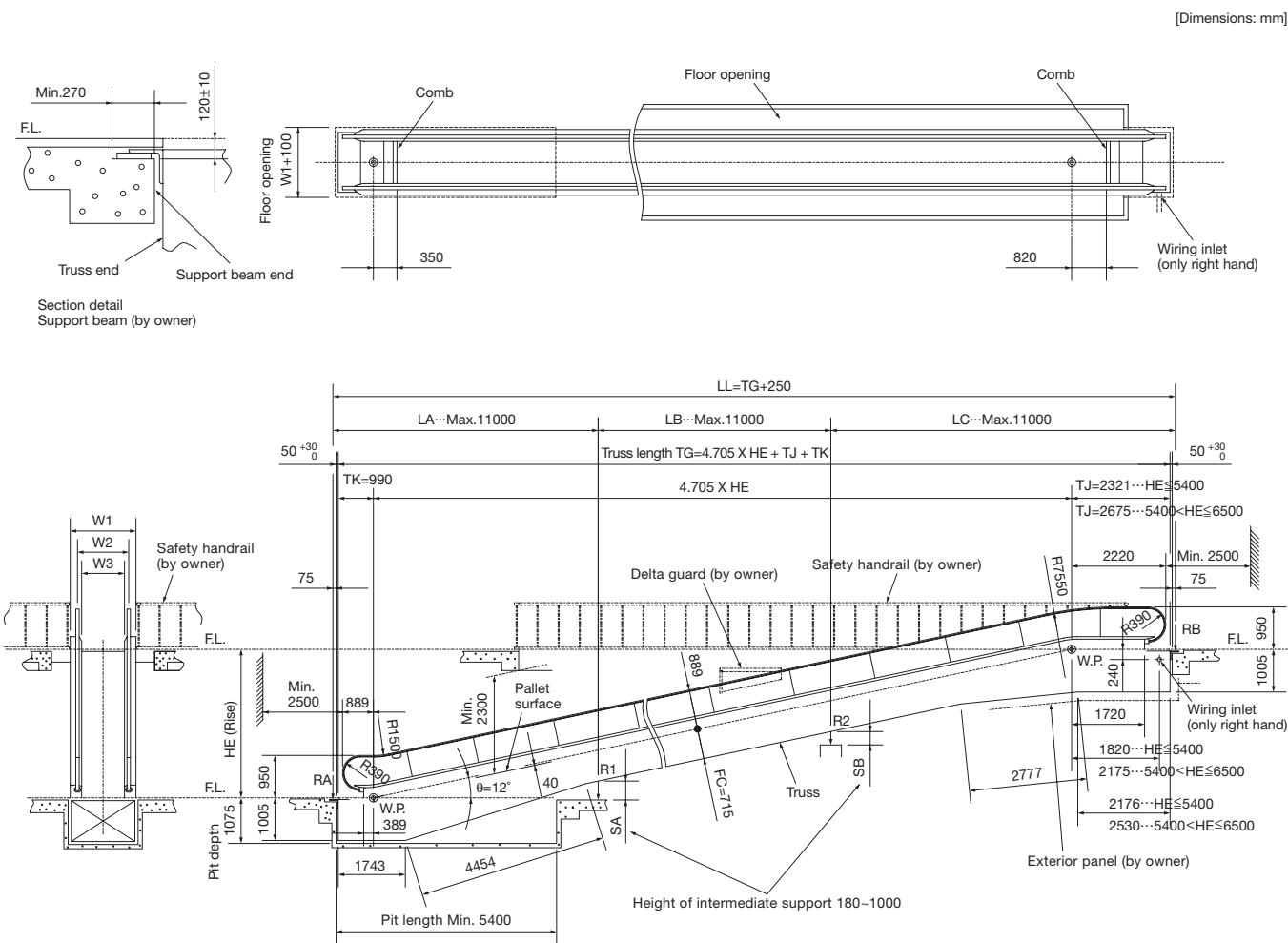

Points to Note with Layout

- Please provide sufficient space in each Moving Walk boarding and landing area in order to ensure smooth traffic flow. This is particularly important for passengers with shopping carts so that they can board or land directly in front of the Moving Walks. Obstacles in this area may interfere with traffic and cause passenger congestion.
- For parallel or crisscross arrangements of Moving Walks, it is recommended to install a dividing handrail nearby the handrails on each floor as shown in the figure to the right, to facilitate smooth traffic for the passengers with shopping carts.

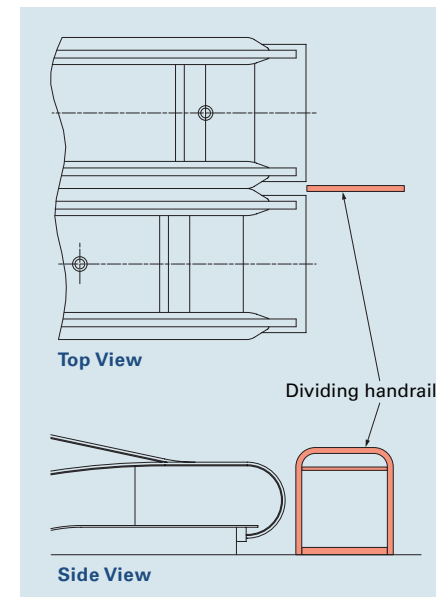

Ordering Information

Please include the following information when ordering or requesting estimates.

- Name and address of building or project
- Type of Moving Walks desired
- Rise (HE) and distance (TG+100mm) between support beams
- Number of units
- Voltage and frequency of power source
- Optional items desired

Works Not Included in Installation Contract

The following items are excluded from Mitsubishi's Moving Walks installation works.

- External finish work on Moving Walks
- Intermediate support beam
- Pit construction, waterproofing and other architectural works
- Wiring and conduits for the main power and lighting to the control panel installed on a truss
- Grounding wires and conduits
- Confirmation tests of shopping carts specified on page 4 of this brochure

Wheeled Devices on Moving Walks

⚠ Wheeled devices such as wheelchairs, shopping carts and baby strollers may run downwards during a ride on Moving Walks unless preventive measures are taken.

- In order to prevent wheeled devices from accidentally running downwards;
  - (1) shopping carts to be used for Moving Walks must fully satisfy the essential requirements and be tested for the confirmation items provided on page 4 of this brochure;
  - (2) wheelchair users without attendants must lock the wheels by brakes or hold the wheels with their hands during rides on Moving Walks;
  - (3) those with baby strollers must hold the handles of the strollers during rides on Moving Walks.

No Foreign Objects on Moving Walks

Ensure that no foreign objects, such as grit and stones, are allowed on the surface of the Moving Walks since they can damage the pallet cleats and comb teeth.

Dimensions (mm)

Type	1200	
	MS-LE	MS-E MS-LB MS-B
Width of Moving Walk	W1	1550
Width between moving handrails	W2	1280
Width between skirt panels	W3	1010

Static load on beam (N) (Dimension: mm)

RA	$\alpha \cdot LA$
RB	$\alpha \cdot LC + \beta \cdot (TJ-1204)/LC$
R1	$\alpha \cdot (LA+LB)$
R2	$\alpha \cdot (LB+LC) + \beta \cdot (TJ-1204)/LC$

Static load factors

$\alpha$ (N/mm)	$\beta$ (N)
5.0	7850

